

Cover the transceiver with the plastic pack

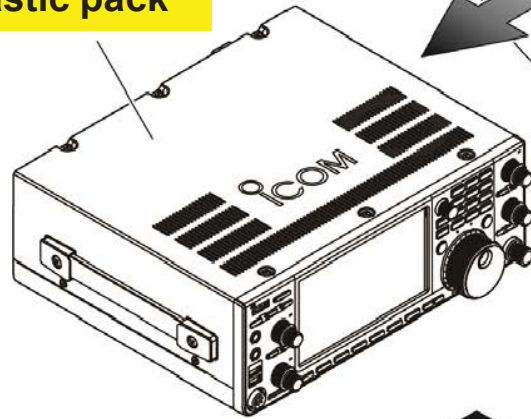

Plastic pack

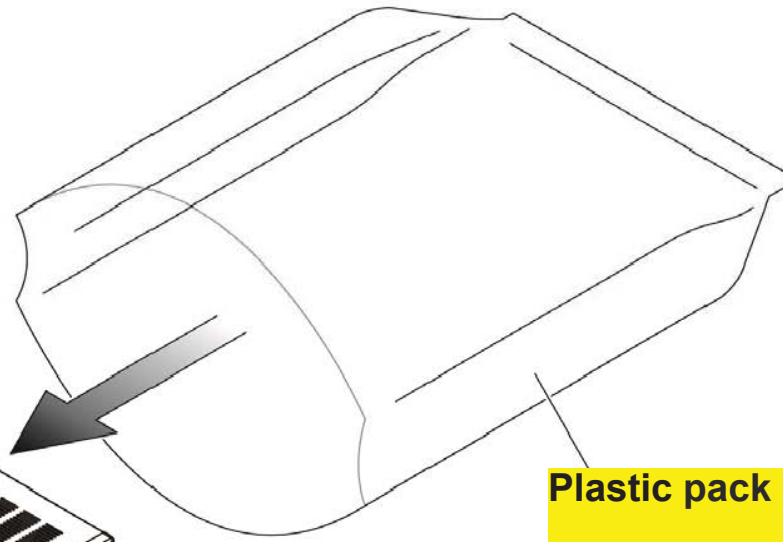

Fold the plastic pack in the order of A to D, as shown below

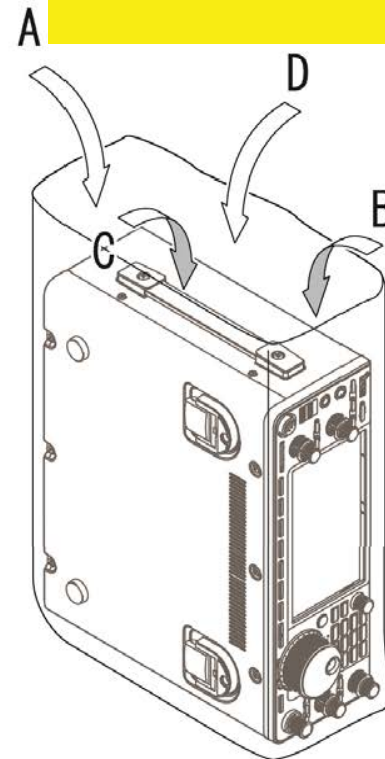

Seal the pack with tape, as shown below

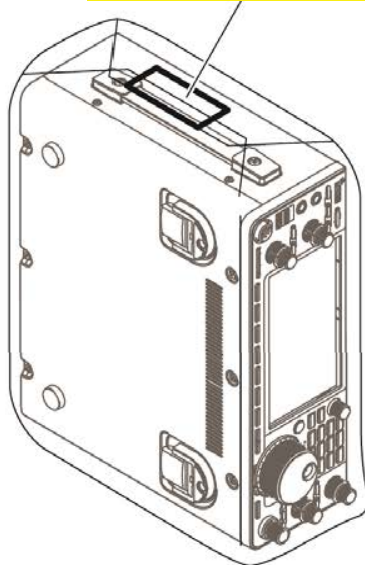

Carefully put the transceiver onto the pad with the feet in the round holes marked in red

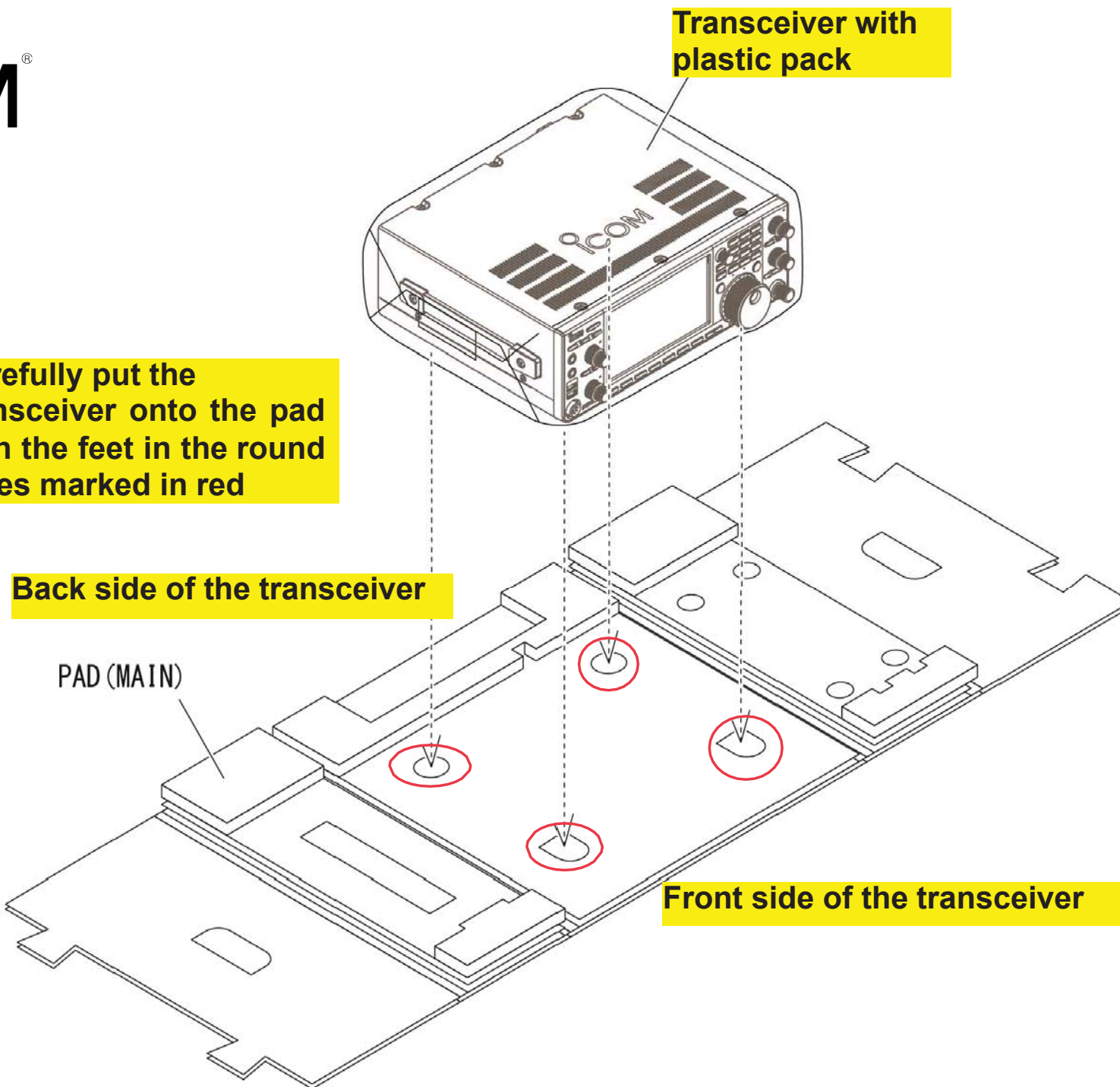

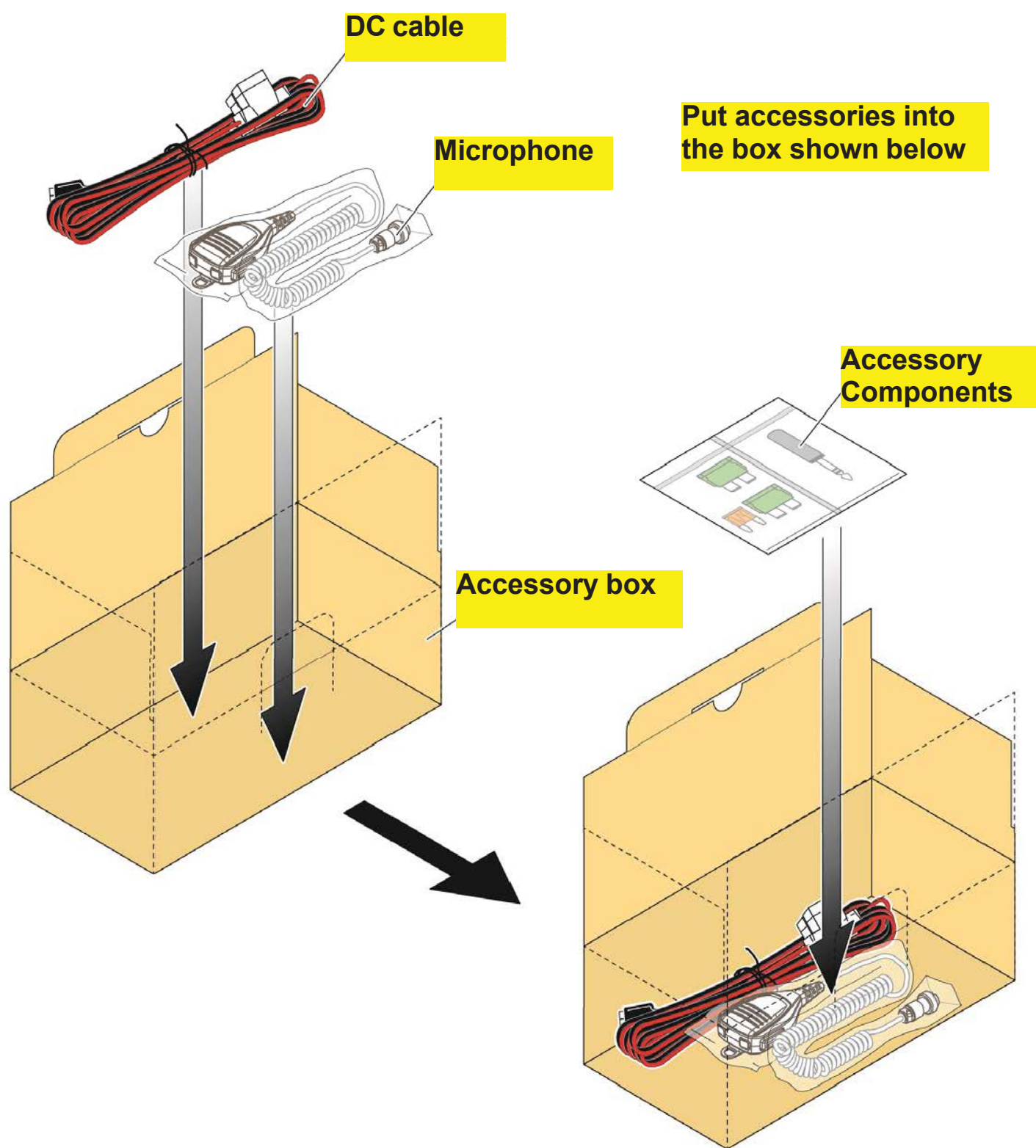

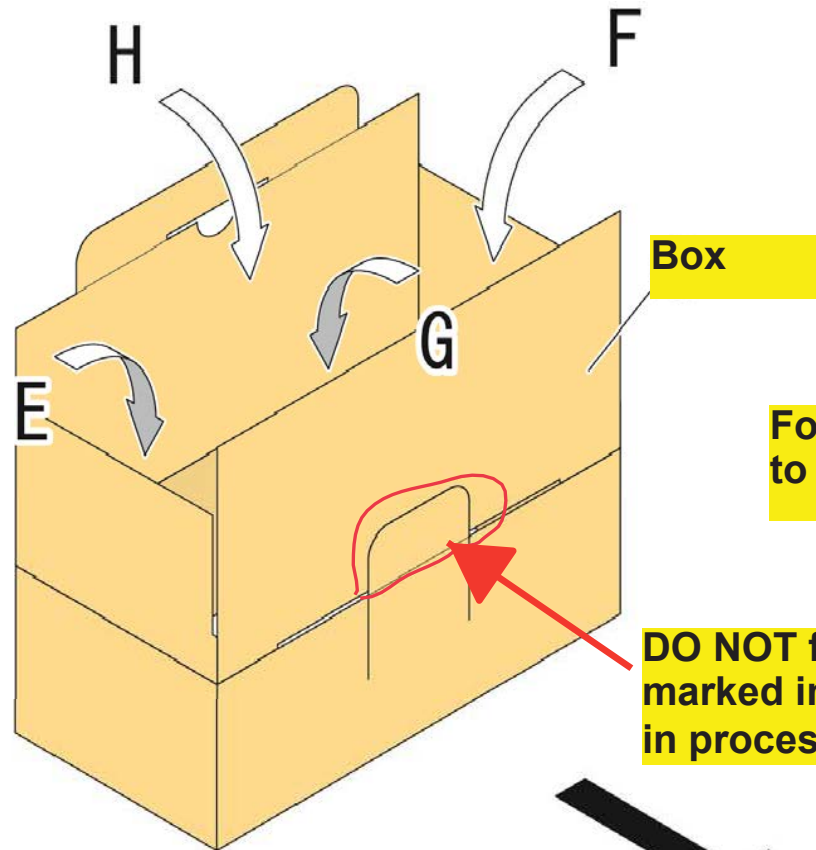

Fold the box in the order of E to H, as shown to the left

DO NOT fold the surface marked in red when folding in process G

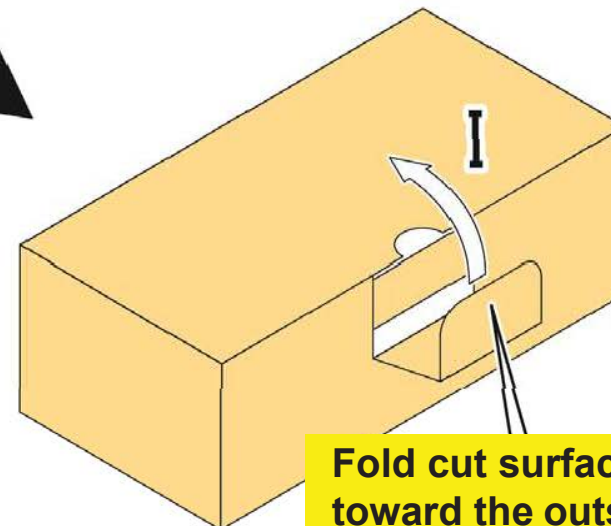

Fold cut surface toward the outside once, then insert it into the slit shown

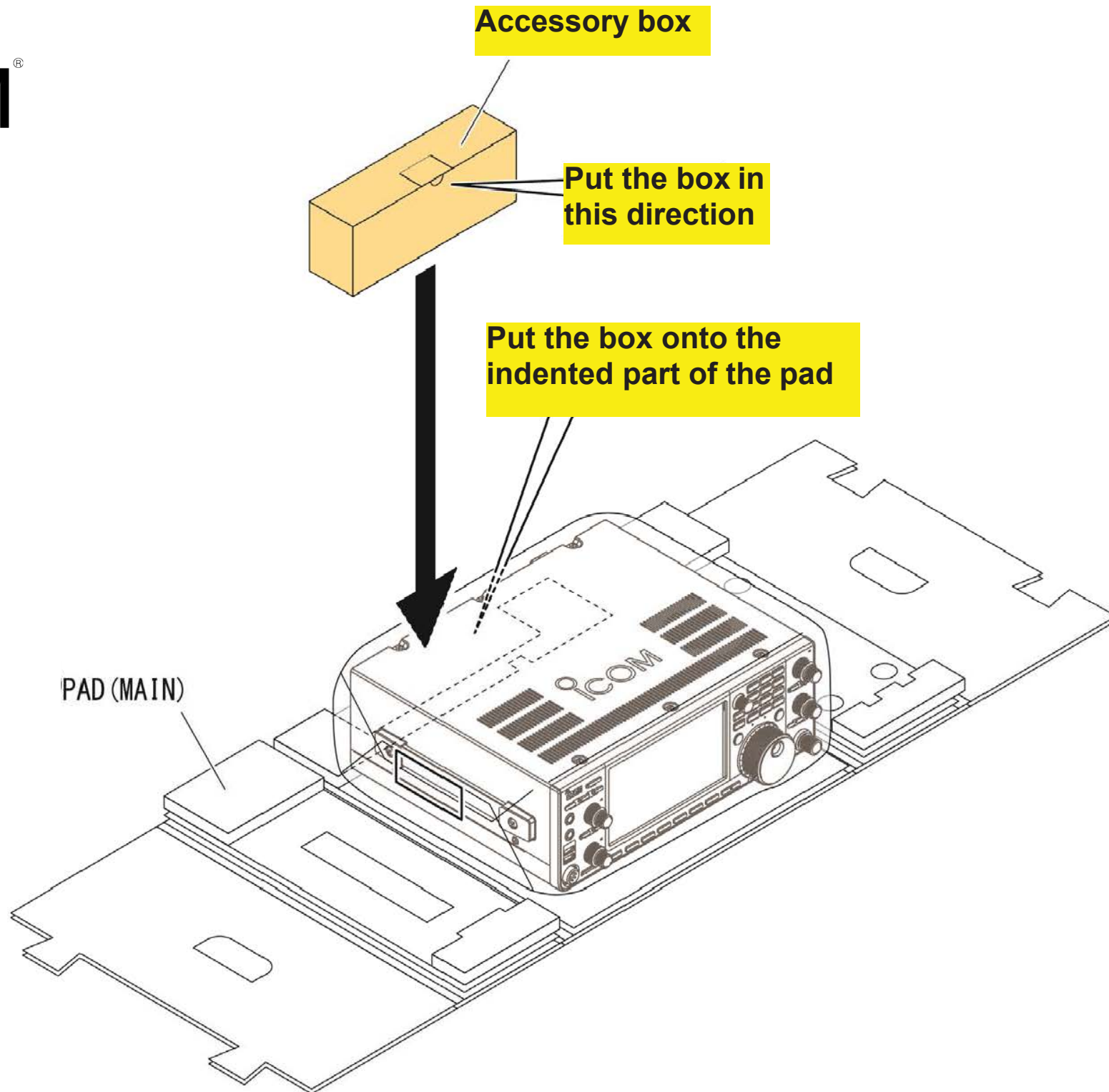

Put the top pad on the transceiver as shown in the figure

Top pad

Longer protrusion

Shorter protrusion

Transceiver

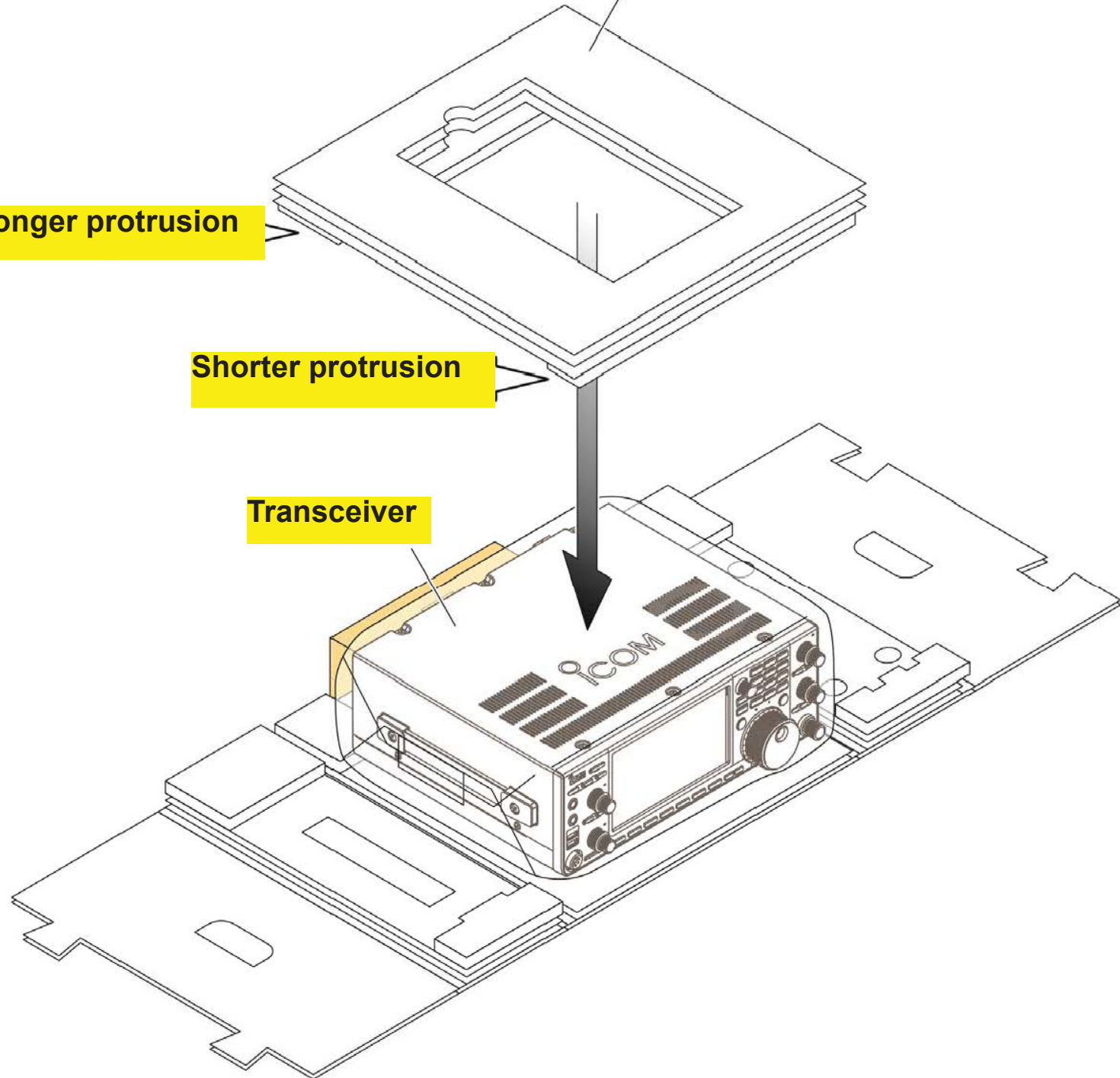

Instruction manual

Put the instruction manual in
the top pad hole

Top pad

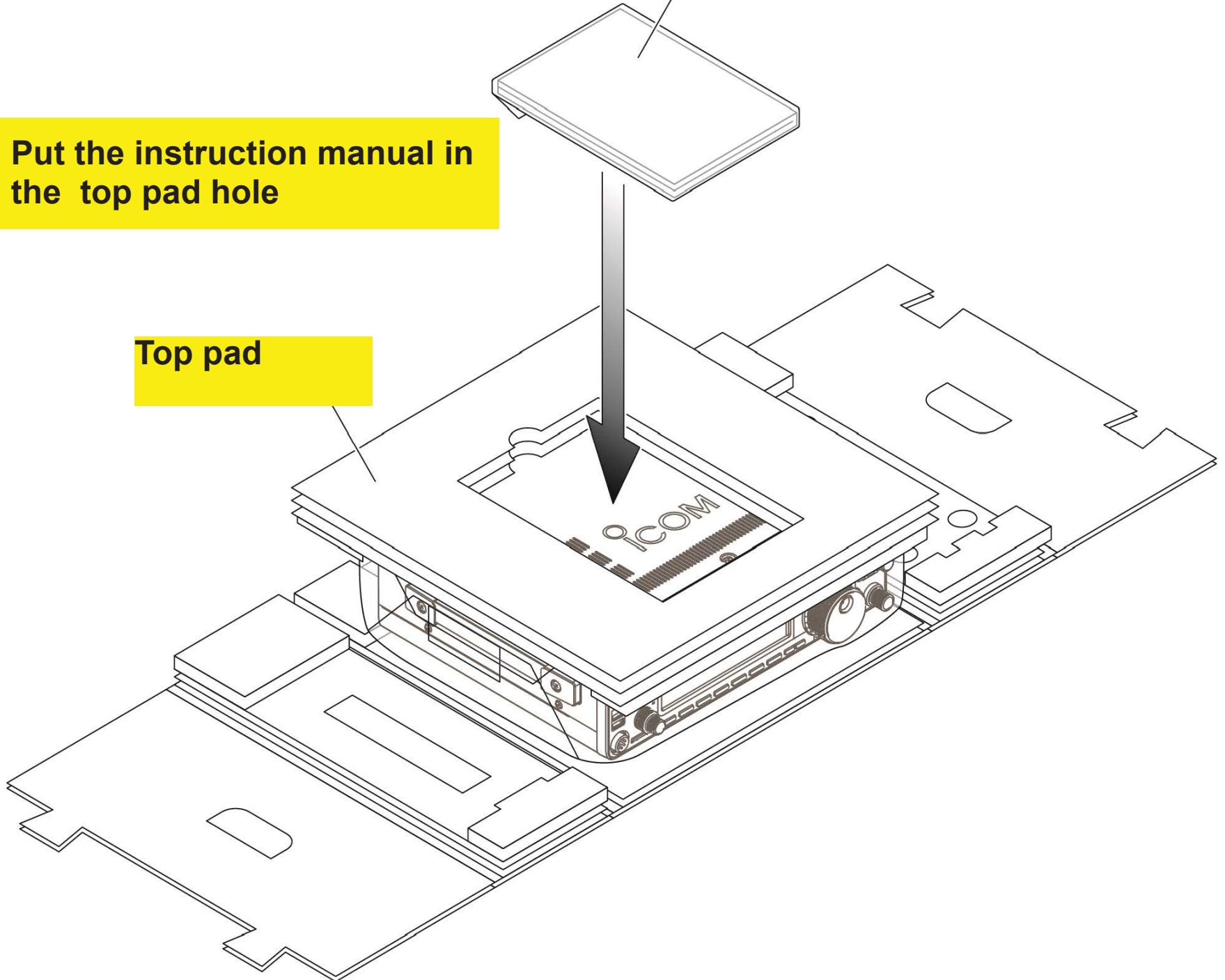

Insert the transceiver case into the inner box.
Note the orientation of the Icom logos. It is
easier to do if two people do it

Fold both edge of the top pad this way

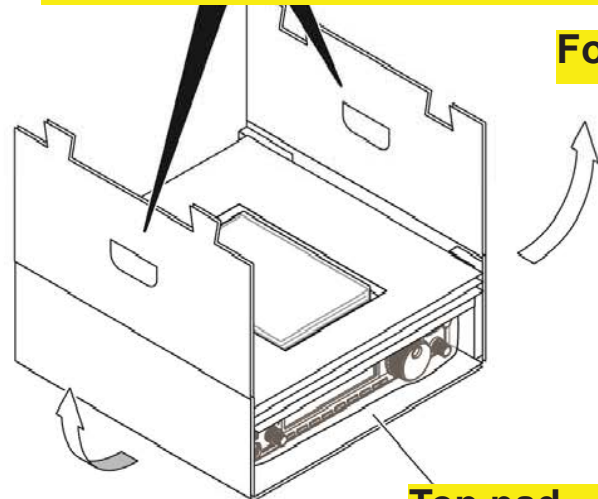

Top pad

Enlarged view

Close this way

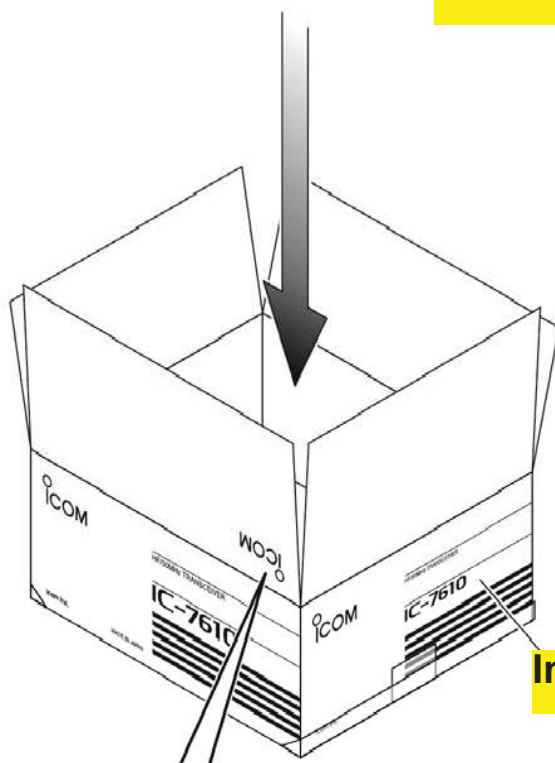
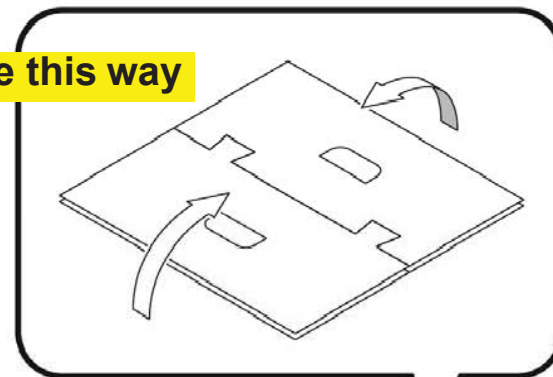

Inner box

Icom logo located here

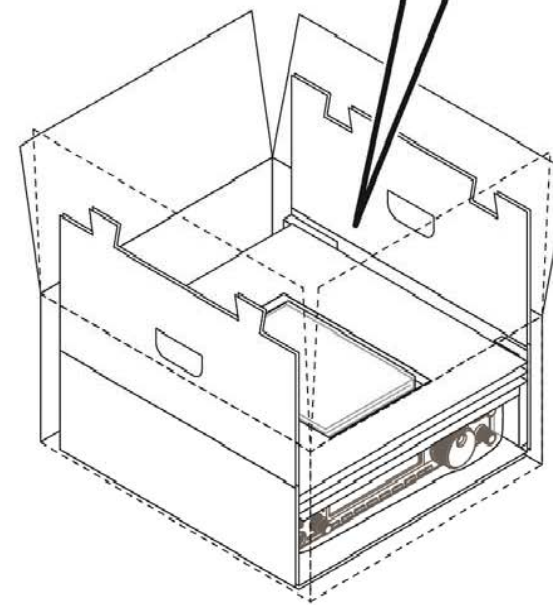

**Fold the surface box
in the order of E to
H, as shown**

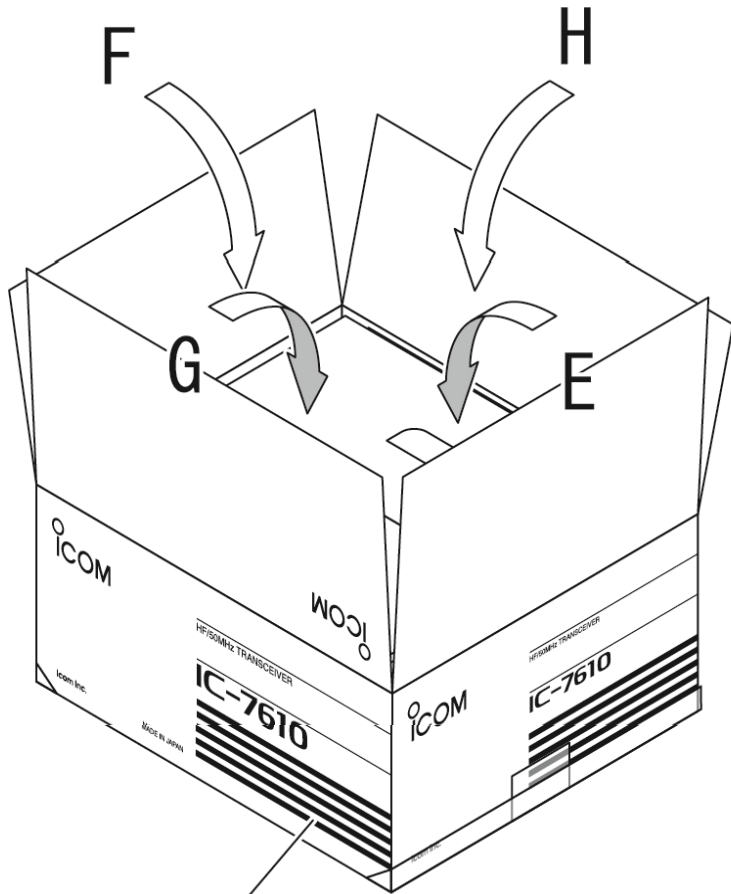

Inner box



**Tape the box like the
letter H, as shown**

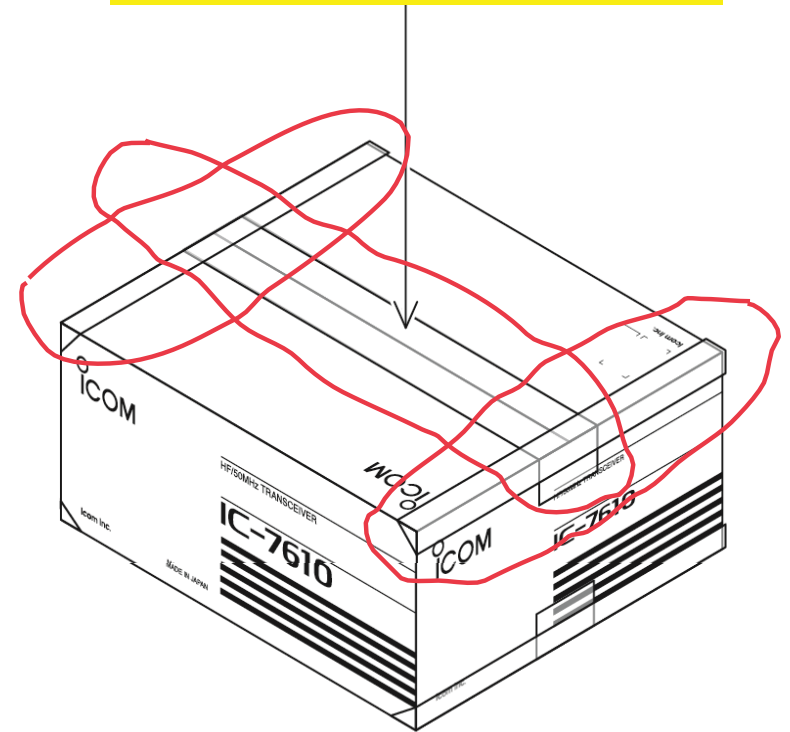

**Insert lower pad into
the outer box**

**The lower pad is
symmetrical, vertically and
horizontally**

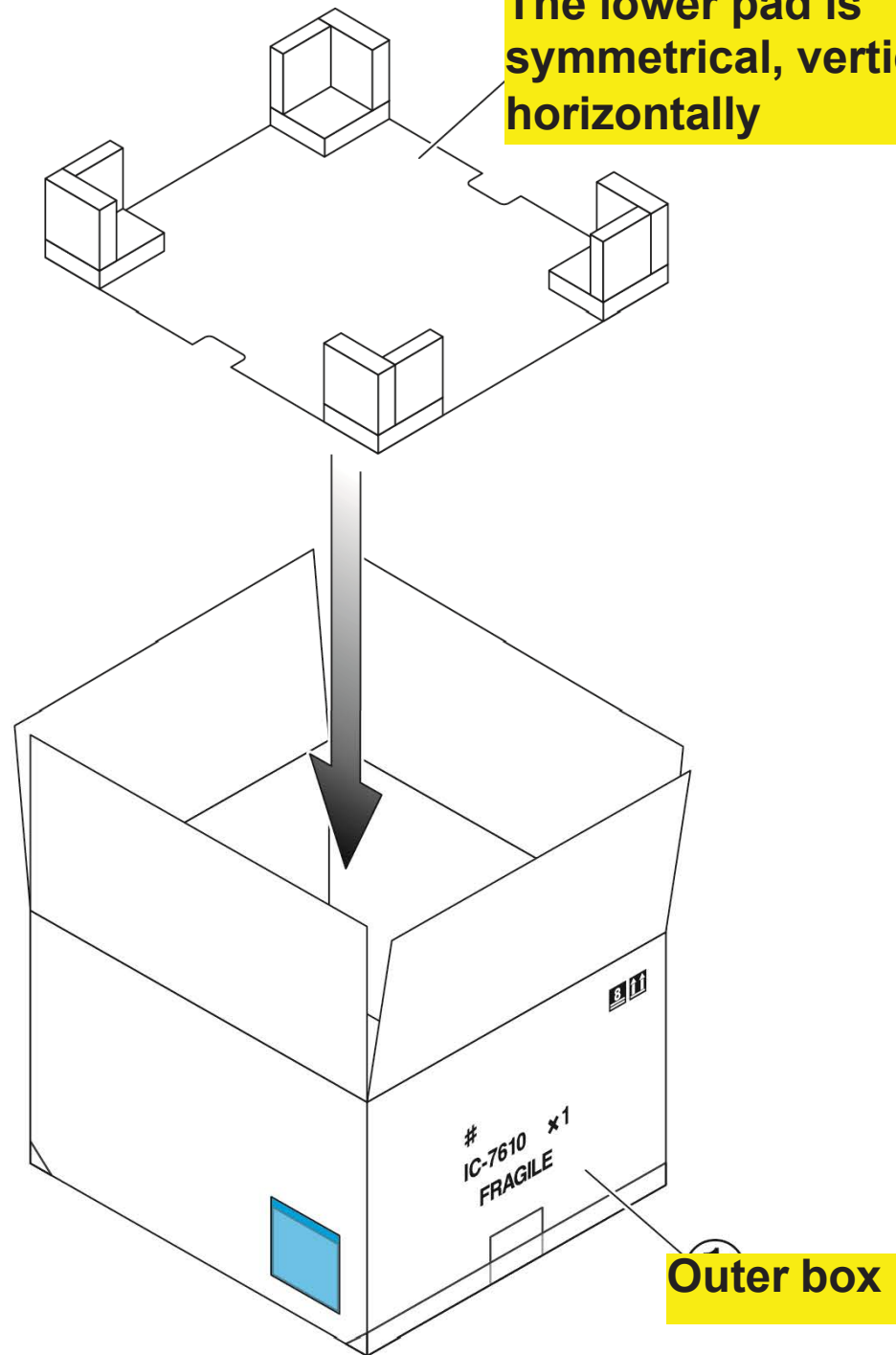

**Put the inner box into
the outer box, as shown**

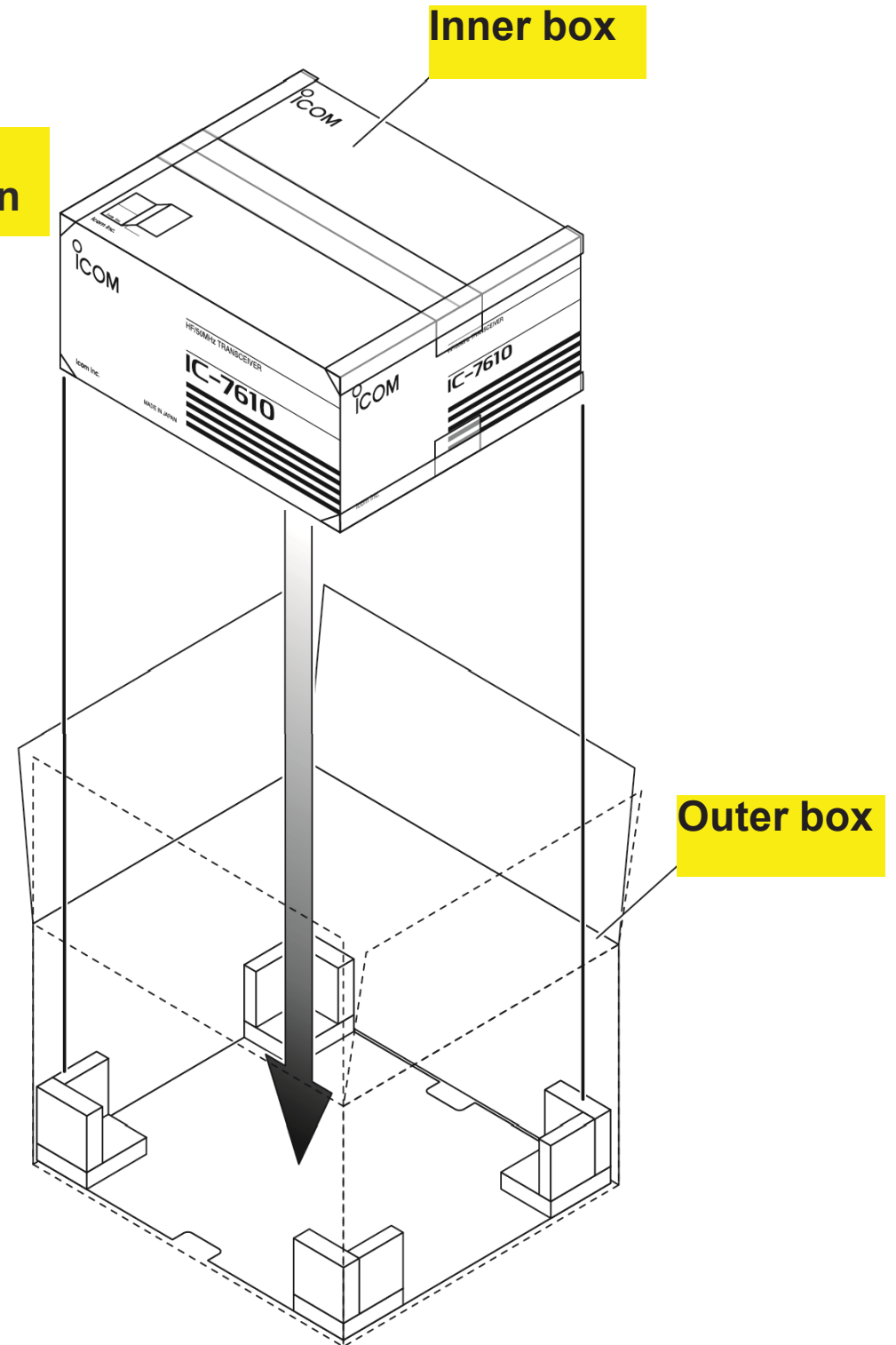

Top pad
It is identical to lower pad

**Put the top pad into
the outer box**

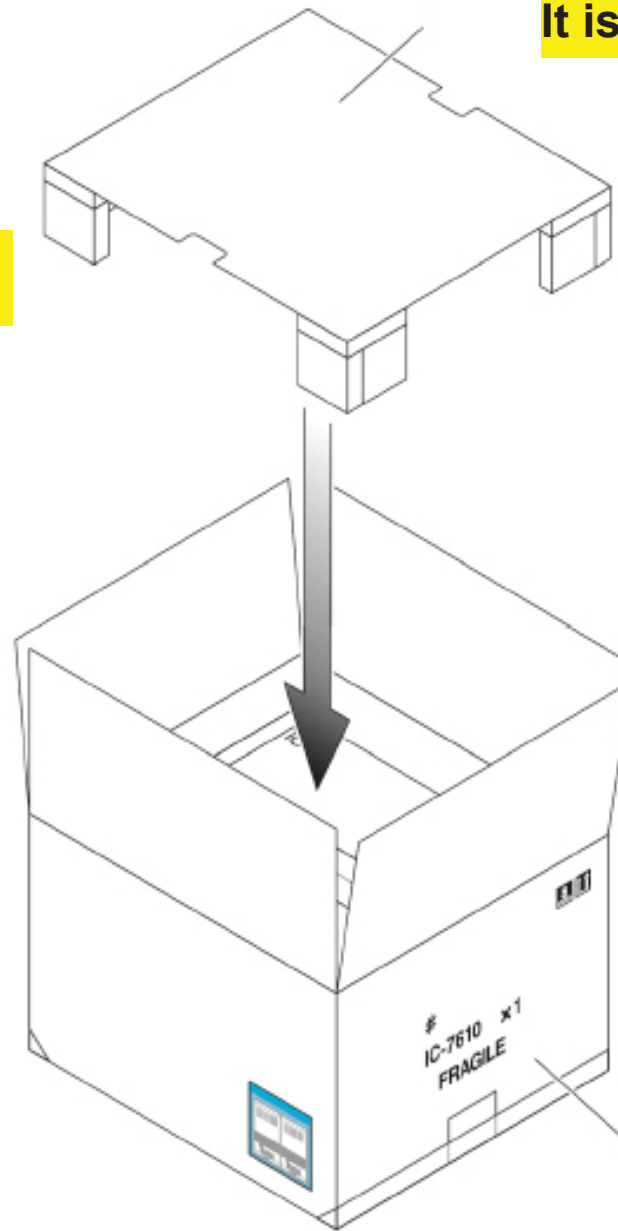

Outer box